

# Group 5

## Village – Waddur *Mandal- Neradigonda (Adilabad)*

Members: *Saurabh (A031)*

*Manoj (A003)*

*Kundan (A053)*

*Abhishek Meena (A055)*

*Abhishek Chaudhary (A024)*

# About district Adilabad

- Adilabad is located in the northern region of Telangana.
- Gateway district to South and Central India
- Got its name from 16<sup>th</sup> century sultan of bijapur “Ali Adil Shah-I”



# About the Village Waddur

- This small village is surrounded by hillocks of southern satmala range and dense forests, making it a secluded place from rest of the surroundings.
- located 54 KM towards South from District head quarters Adilabad.
- Under the mandal Neradigonda, which also serves as its Head post office



# Social map of Waddur village

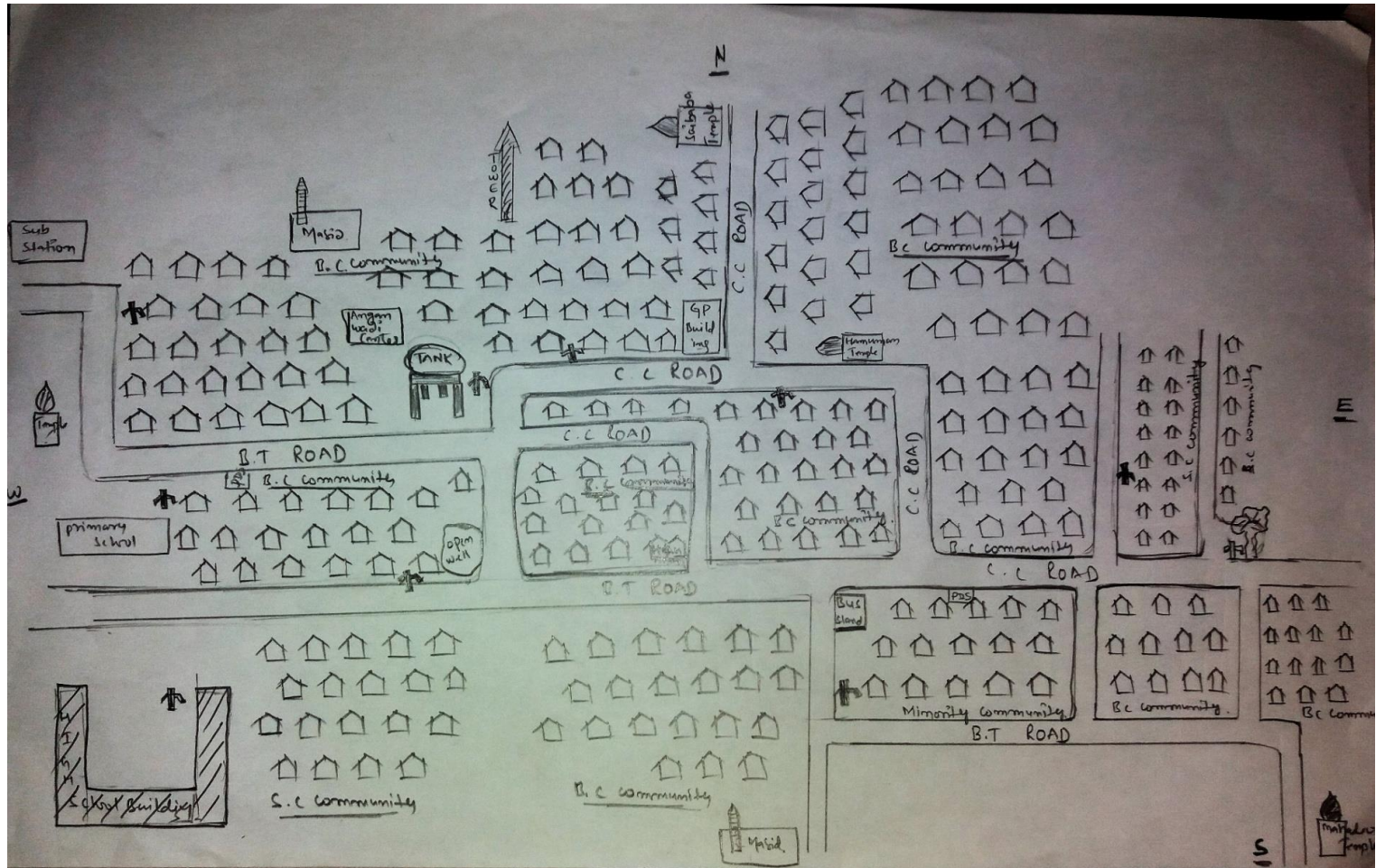

# Population profile of the village

No of Households	Total population	Male	Female	Population in 0-6 yrs age group	Male (0-6yrs)	Female (0-6yrs)
654	2626	1292	1334	294	64	45

Population (SC)	Population (SC) Male	Population (SC)Female	Population (ST)	Population (ST) Male	Population (ST) Female
153	75	78	9	4	5

# Resource map of Waddur village

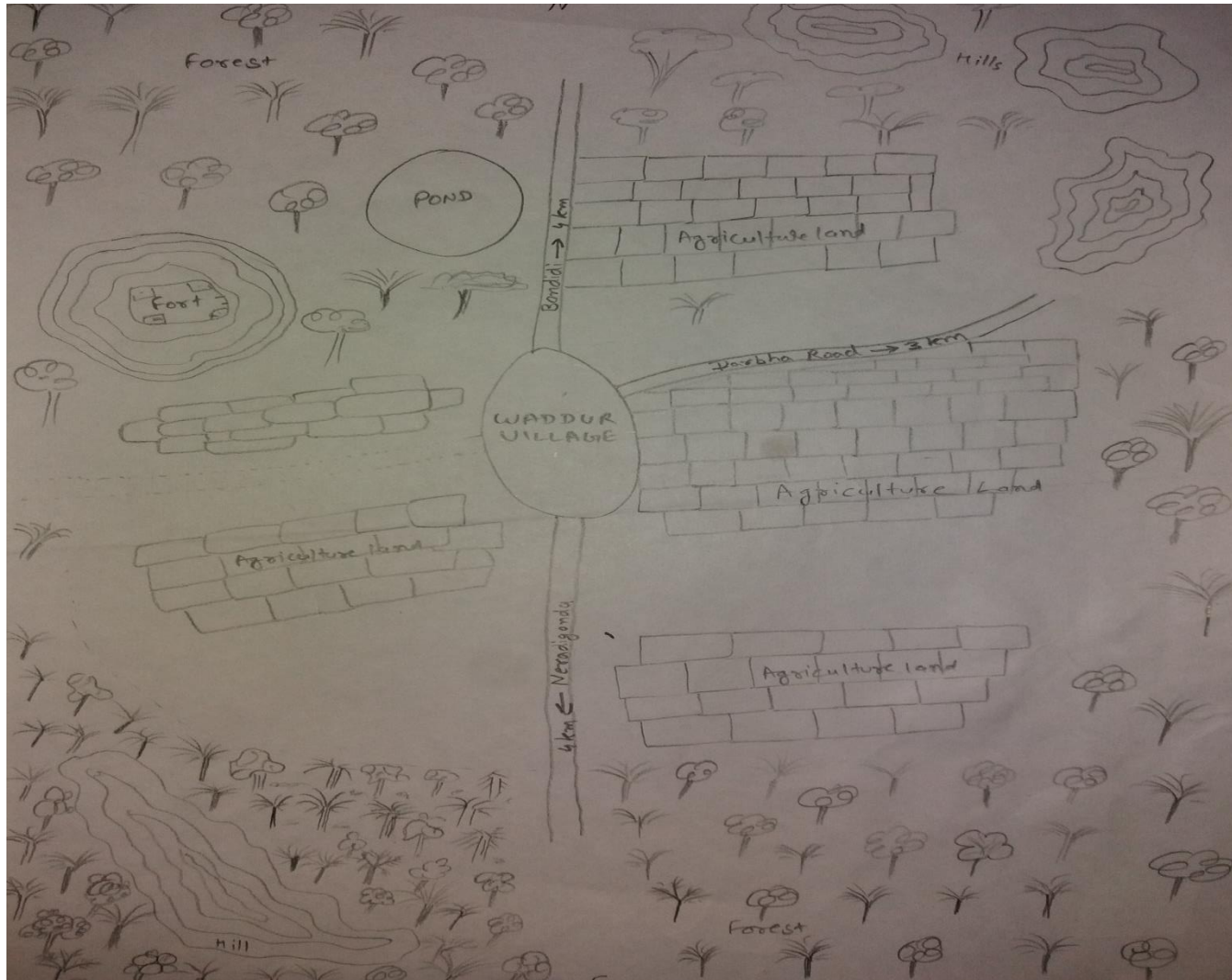

# Connectivity of the village

- Nirmal is the Nearest Town to Waddur. Nirmal is 35 km from Waddur. Road connectivity is there from Nirmal to Waddur.
- The village has its own post office and the pin code of Waddur village is 504323.
- Nearest railway station is Kinwat which is 44.6 km from the village.
- Road connectivity is good. Neradigonda mandal is 4 kms from the village. NH-44 passes through Neradigonda.

# Village Timeline

Time	events
1948	Police Action in 1948 to merge Nizam's dominion with Indian Union
1960	Establishment of BIDI Factory
1970	Electricity reached in the Village
1982	High School in the village
1992	First television in the village
1995	Water tank was built
2001	Pacca Road connectivity to Neradigonga(parent mandal)
2001	First LPG connection
2002	First landline in the village
2004	ANM(Auxiliary Nurse Midwife ) centre
2006	MGNREGA programme started
2014	Mobile Tower in the village
2014	Electric power substation(33/11kv)





## Primary sources

- AGRICULTURE
- MGNREGA
- FISHING
- BEEDI MAKING
- ANIMAL HUSBANDRY
- FURNITURE MAKING
- FOREST PRODUCTS

## Secondary sources

- Flour Mills
- Medical stores
- Meat shops
- Dairy Shops
- General stores

# Beedi Making

- Beedi making is a major source of employment for the village women.
- There are total 302 registered beedi workers in the village.
- The raw material is *Kendu Patta* and tobacco leaves that are provided by the beedi company.
- *Kendu patta* is also collected by the villagers from the nearby forests.
- There are 6 companies working nearby the villages.
- Beedi workers handover the final product to these companies which further send the beedi packs to the beedi factory in Neradigonda.
- The beedi made by the villagers are further exported to Gujarat.



# MGNREGA work

- There are total 975 registered job cards under MGNREGA scheme.
- Creation of trenches are for holding and diverting the rain water is going on under the MGNREGA scheme.
- Almost 490 workers are working on all sites in the village.
- wages of Rs. 205 is provided to each labourer. Rs 5 for bringing water daily and Rs. 10 for the maintenance of their tools is also being provided.
- Amount is credited directly to the post office account of the labourers.
- Issues in the payment delivery. For the past 3-4 months the payment is not provided to many workers.



# Agriculture Details :-

- 550-600 households involved in agriculture.
- 300 households having their own land.
- Others are landless labourers.
- Cotton, soya, gram, jwar, wheat, mung dal, arahar, coriander are chiefly grown.
- Seasonal vegetables like brinjal, bitter-guard, tomato, turai
- Around 200 tubewells for the irrigation process.
- Irrigation sources being rainwater and tubewells.
- Ground water level decreases in summer, causing hindrance in irrigation.

# Agriculture Details :-

## Land distribution

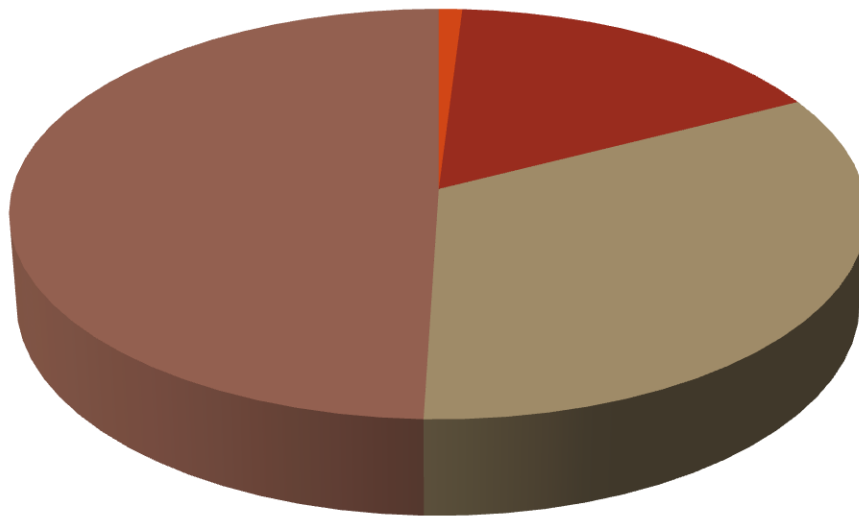

■ large land owners(20 acres or more) 1%

■ medium land owners(5-20 acres) 16.67%

■ small land owners (less than 5 acres) 33.34%

■ landless labour 50%

# EDUCATION :-

- Schools play major role in imparting education. There are three schools in the village up to class 10th level:-



1. Primary school:- Class 1 to 5



2. Secondary school:- Class 6 to 10



3. Upper Primary school:- (Urdu medium), class 1 to 7.

# Education (cont..)

## Enrolment details

- Primary school(MPPS Waddur)

Total	Boys	Girls
148	71	77

## Number of Teachers- 5

- High School (ZPHS Waddur)

Total	Boys	Girls
163	96	67

- Number of Teachers – 7 ; Non-Teaching staff:- 3

# Education (cont..)

- Mid Day Meal Scheme
- Extra curricular activities
- Sports activities
- Library is available in High School
- Computer facilities also available
- projector facilities available in Village High School.
- Free uniform and textbooks
- Lack of sufficient desks and benches for the students.
- Lack of compound wall and girls toilet.



# Aanganbadi in the village

- There are three working anganbadi centers
- Aanganbadi kendra- 1  
Total registered children- 25  
Operational in Upper Primary School
- Aanganbadi kendra- 2  
Total registered children- 18  
Separate building is provided by Panchayat
- Aanganbadi kendra- 3  
Total registered children- 15  
Operational in rented building (not in good condition)



# Health Care

- One Health Sub-Centre in the village.
- One ANM and 2 Asha workers.
- 4 RPM's in the village.
- One Medical shop
- Primary Health Centre is 4 km away in Neradigonda.
- 108 and 102 ambulance service is available from Neradigonda.



# Health Care (cont..)

- Operation theatre at PHC
- Emergency Ward at PHC
- All basic medicines are available
- State Schemes(KCR Kit)
- Referral options:
  1. Nirmal (30km): area hospital and MCH
  2. RIMS Adilabad(50 km)



# Health Care (cont..)

## KCR Kit

- Total pregnant women in the village: 25
- Previous year 52 beneficiaries of KCR kit.
- 12k for boy child and 13k for girl child to be paid in 4 instalments (for first two child)

## Health issues in the village:

Disease	Mandal level	In Waddur Village
Filaria	33	3
Tuberculosis	13	2
HIV	13	1

# Gram Swaraj schemes

## ➤ Pradhan Mantri Ujjwala Yojana

- Aims to safeguard the health of women and children by providing them with clean cooking fuel- LPG
- In Waddur village most of the household already have LPG connection
- Many household got the LPG connection through Deepam pathakam scheme of state government.
- Total beneficiary of Ujjwala Yojana in the village: 10
- Almost 550 household out of 654 are having LPG connections.

## ➤ Saubhagya (pradhan mantri sahaj bijli har ghar yojana)

- All households were already electrified before the launch of the scheme.
- A power sub-station of 33/11kv was installed in 2014.
- After the installment of sub-station the village is getting almost 24 hrs electricity everyday.



## ➤ **UJALA Scheme**

- Aims to promote efficient use of energy at the residential level by promoting LED bulbs
- Currently not being implemented in Waddur village.
- Most of the households are using either LED's or CFL.  
All LED street lights in the village.

### ➤ **Pradhan mantri Jan Dhan Yojana**

- Aims at financial inclusion of the people.
- Total 1400 zero balance accounts
- These accounts are used for various subsidies and pension schemes.

### ➤ **Pradhan Mantri Jeevan Jyoti Bima**

- Available to people in 18-50 yrs age group.
- Annual premium of Rs.330

### ➤ **Pradhan Mantri Suraksha Bima**

- Available to people in 18-70 yrs age group.
- Annual premium of Rs. 12



➤ Jan Dhan Accounts and Bima Details of Waddur village.

Telangana Gramin Bank details (Waddur village)

Total number of Jan Dhan Accounts:- 243

Total number of jeevan jyoti Bima holders:- 93

Total number of jeevan Suraksha Bima holders:- 124

Scheme	Claims	Claims processed
Jeevan jyoti Bima	2	0
Jeevan Suraksha Bima	1	0

## ➤ **Mission Indradhanush**

- It aims to immunize all children under the age of 2 years, as well as all pregnant women against seven vaccine preventable diseases.
- The vaccines are already covered in KCR Kit and other State health schemes.
- No separate implementation of Mission indradhanush in the mandal.



# State Schemes

## ➤ **Mission Bhagiratha**

- Is a project for safe drinking water for every village and city households
- Pipelines along with optical fibre are being laid



## ➤ Haritha Haram

- 8700 Sagwan plants to 16 Farmers
- 40 Sagwan plants to 2 Schools



# Swachh Bharat Abhiyan

- Waddur is Open defecation free village.
- Still open defecation was observed.
- Overall cleanliness of the village is good.
- Drainage is not well planned.
- Water logging was observed at several places.
- Magic soak pit and normal soak pits were installed at several places.



# Swachh Bharat Abhiyan(Cont..)



# Swachh Bharat Abhiyan(Cont..)



# Issues

- There is no properly planned drainage system in the village
- Open Soak pits are not cleaned from time to time
- No kitchen shed, compound wall, dual desks and separate toilet for girls in High School
- Open defecation is observed
- Anganwadi centres and Health sub centre are very congested
- Two Mandals share one 108 ambulance



# Suggestions

- Gram Panchayat and district administration need to sensitize villagers against open defecation, to not clog existing drains, soak pits and get them cleaned from time to time
- High School should meet its minimum requirement standards
- Anganwadi and health centre should be moved to a spacious place









SHOT ON REDMI NOTES PRO  
MI DUAL CAMERA

# Thank You

