



VILLAGE STUDY
Village: NIZALAPUR

Mandal: Moosapet

District: Mahbubnagr

Team Members:

Ajay Kumar
Ajay Meena
Surendra K.
Pankaj Saini
Narottam

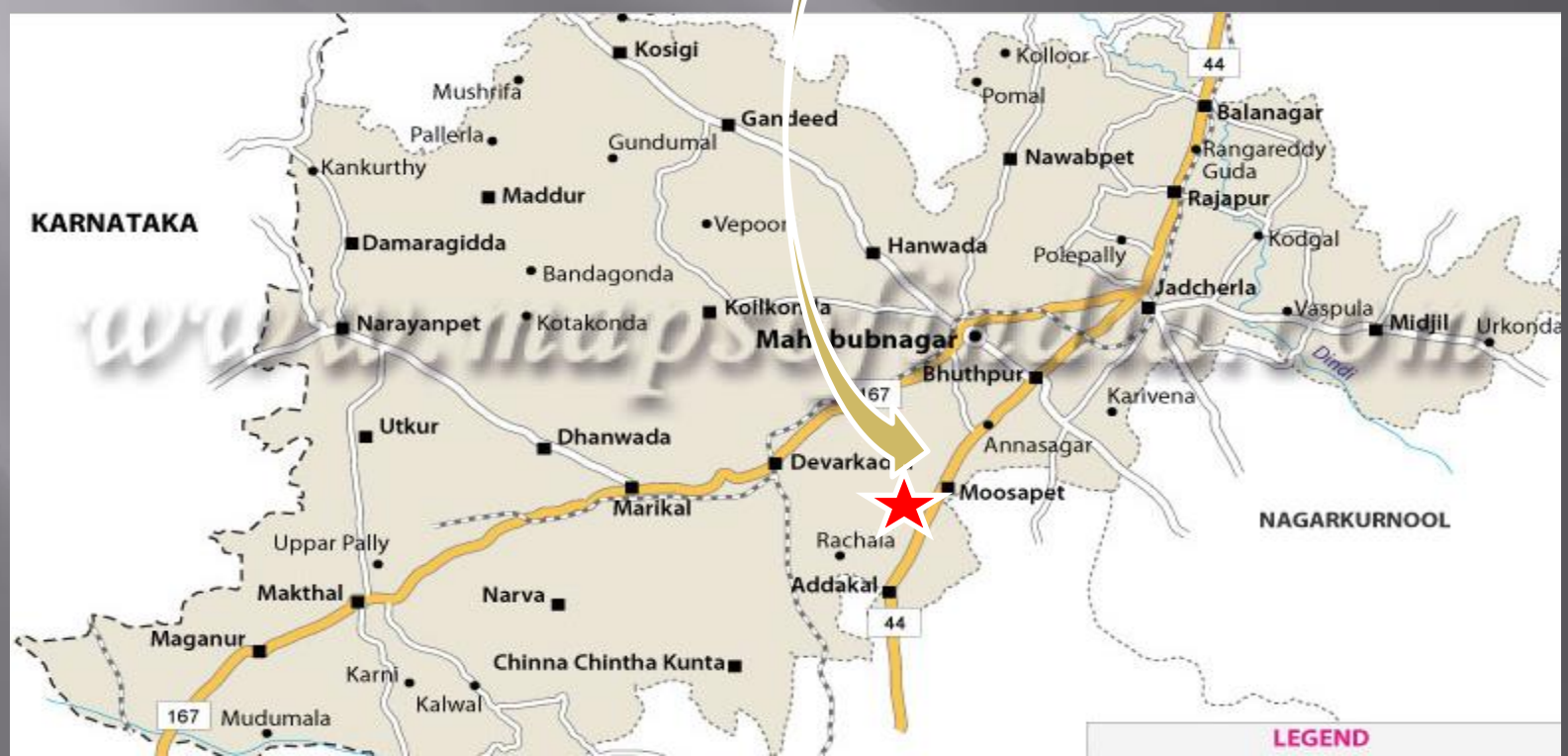

VILLAGE MAP

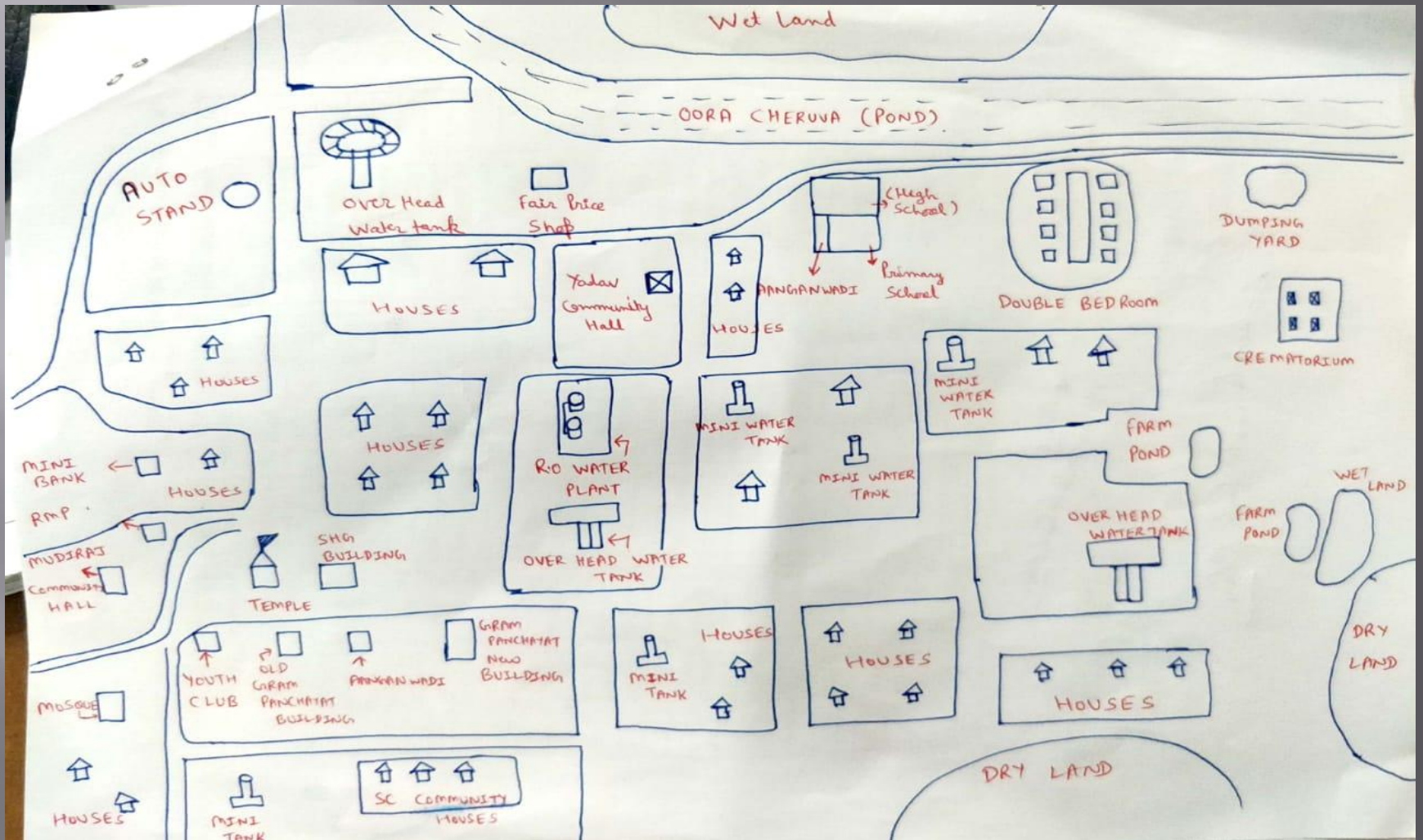

About the village

- District: **Mahabubnagar** Mandal: **Moosapet**
- It is situated 17km away from sub-district headquarter Addakal and 32km away from district headquarter Mahbubnagar.
- The total geographical area of village is 499 hectares.
- Mahbubnagar is nearest town to Nizalapur which is approximately 28km away.

S. No.	Caste	Population	House hold	Male	Female	Transgender
1	SC	212	48	110	102	0
2	ST	14	4	8	6	0
3	BC	2496	517	1274	1219	3
4	OC	104	26	53	51	0
5	Minority	46	9	22	24	0
Total		2872	604	1467	1402	3

Population

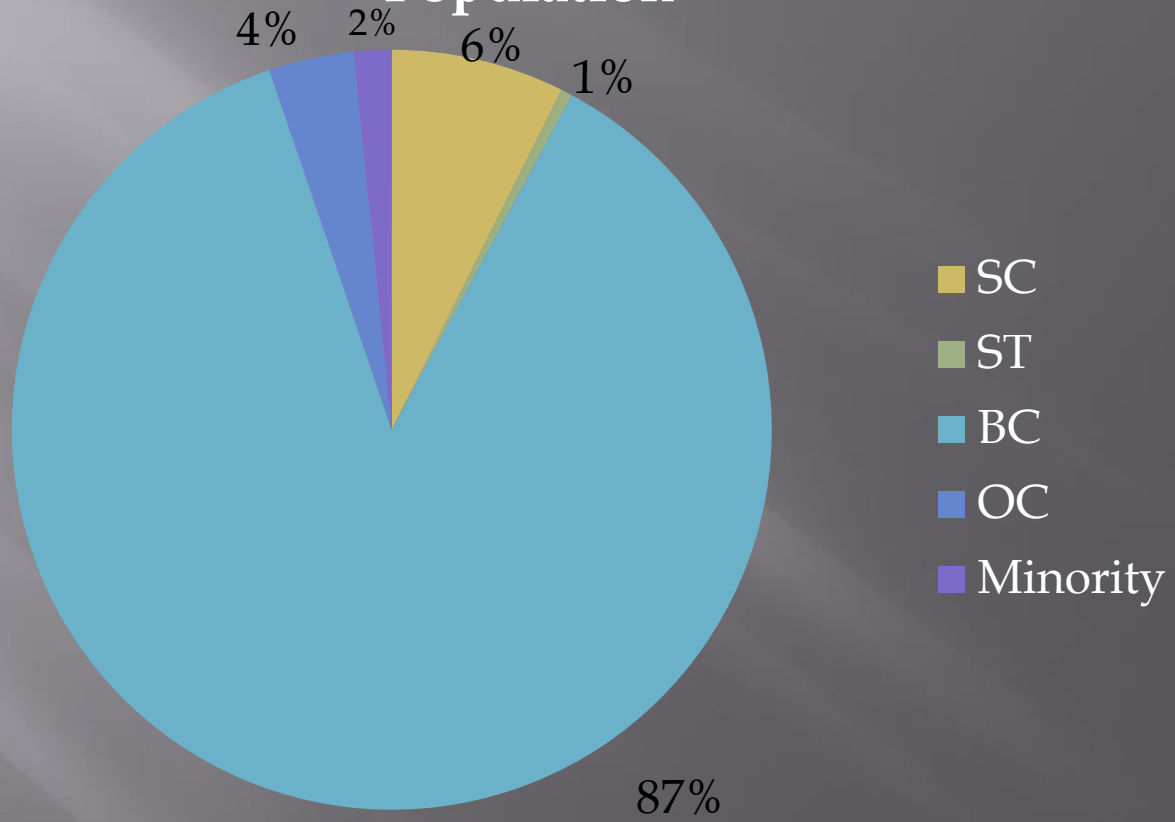

Resource Map



Resources identified

I

Natural Resources

- Land
 - Agricultural Land
 - Waste Land
 - Water
 - Pond
 - Tank
 - Forest
 - Fallow Land
 - Aforestation
- Sandy Loam

Infrastructural Resources

- Water Tanks
- Fishing Ponds
- Road
- Overhead Water Storage
- Borewells

Institutional Resources

- Gram Panchayat
- Zila Parishad High School
- Anganwadi
- Health Sub Centre
- Village Organisation
- Bank Mitra

Timeline

S.No	Particulars	Year
1	Old Panchayat Building	1957
2	Primary School	1959
3	High school upto 7 th class	1970
4	Electricity	1978
5	Self Help Group	1995
6	LPG	2000
7	High school upto 10 th class	2005
8	NREGA	2006
9	Fair Price Shop	2011
10	Mini Bank	2013
11	Integrated House Hold latrine (IHHL)	2015
12	Any Time Water (ATW)	2016
13	Dumping Yard	2017
14	Mission Indradhanush	2017
15	Crematorium	2018
16	Ammawadi Scheme	2018
17	Rythu Bandu Scheme	2018

Social Security Pensions

S.No	Type	Number of pensioners	Amount of pension(In Rupees)
1	Old Age Pension	145	1000
2	Widow	113	1000
3	Disabled	47	1500
4	Single women	14	1000
5	Toddy Tappers	3	1000
TOTAL		322	

Ration Cards

S.No	Type	Number of Cards
1	Food Security Cards	630
2	Anthyoda Ann Yojana Cards	48
3	Annapurna Cards	2
TOTAL		680

Water supply

S.No	Type	No
1	Over Head Storage Reservoir(OHSR)	2
2	Ground Level Storage Reservoir(GLSR)	9
3	No. of Hand Pumps	5
4	No. of Tap connections	306
TOTAL		680

VENN DIAGRAM

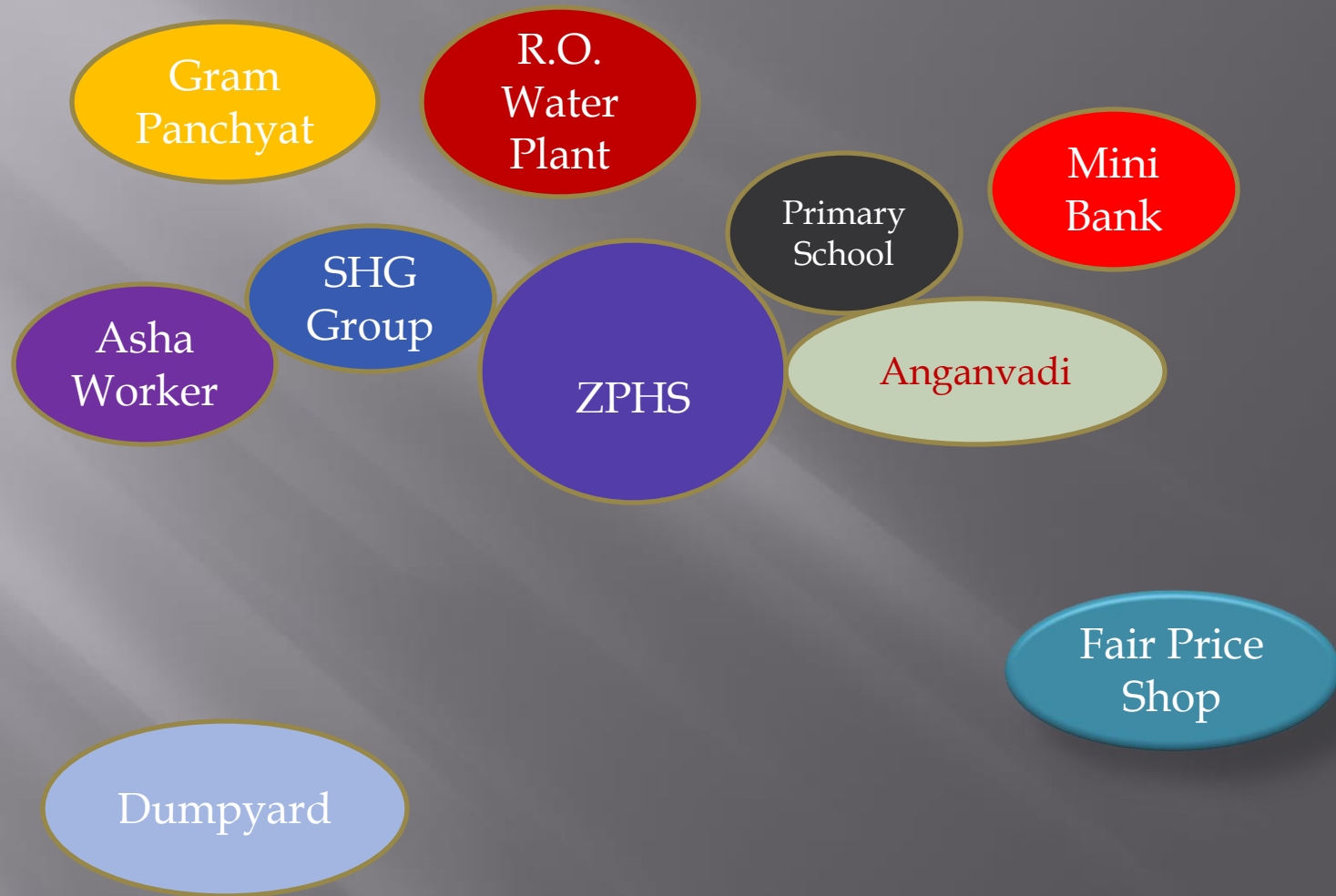

Agriculture And Allied Activities

GEOGRAPHICAL DETAILS

- ❖ Total Geographical area 1234 acre.
- ❖ Wet area 421 acre.
- ❖ Dry area 489 acre.
- ❖ Total cultivable area 910 acre.

FARMERS

- Marginal (<2.5 acres) -204
- Small (2.5 – 4.9) - 323
- Others (>5)- 14



Crops:

Major crops- Paddy

Minor crops- Red Gram, groundnut

Live stock- Chicken, Goats and Cattles

Schemes:

1. Rythu Bandu Scheme

2. Seed Village Programme

3. Subsidized Seed Programme

4. Farm Mechanisation Scheme

5. Land Improvement Schemes

EDUCATION

1. No. of Primary School – 1
2. No. of Zila Parishad High School – 1
3. No. of Anganwadi- 3
4. Literacy Rate is 56%.
5. 100% enrollment rate in schools
6. Dropout in school is Zero.



Class	Boys	Girls	Total Students	Teachers	Student To Teacher Ratio
I – V	64	65	129	3	43:1
VI – X	48	53	101	7	14:1

HEALTH

- ❑ Percentage of Immunisation in the village - 100 %
- ❑ Institutional delivery in the village - 100%
- ❑ Infant mortality rate - 0%
- ❑ Maternity mortality rate - 0%
- ❑ No. of clinic in the village - 1
- ❑ Total No. of ANM worker - 1
- ❑ Total No. ASHA workers - 2
- ❑ Nearest hospital-Janampet (9 km from the village)



NREGA



- ▣ Number of job cards-584
- ▣ Number of person engaged-887
- ▣ Construction under NREGA:-
 - Farm Pond
 - Crematorium
 - Dumping yard
 - Soak Pit
- ▣ Wages - Rs.-205 per cubic meter

OBSERVATIONS

ATW(Any time water) machine :- Rs 3/20L



OBSERVATIONS (contd.)

BANK MITRA

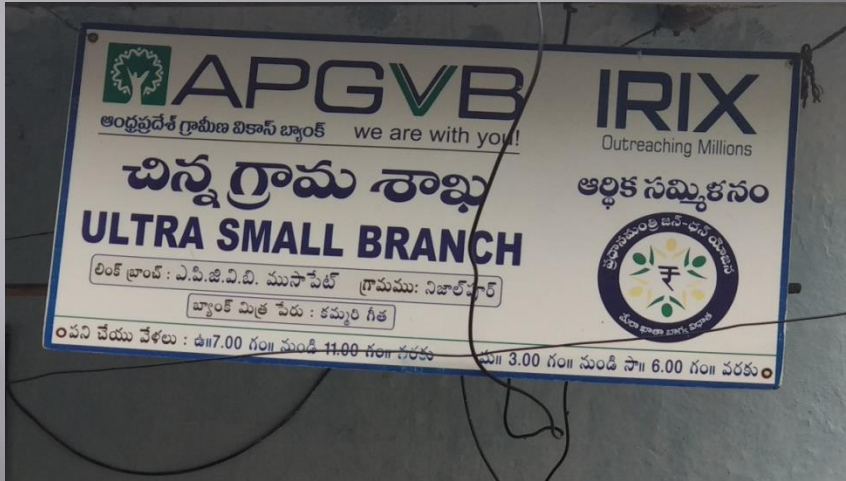

Magic Soak Pit



Observations (Contd.)

FAIR PRICE SHOP



CHECK DAM



2018/5/25 14:37

Observations (Contd.)

DOUBLE BED ROOM SCHEME:



Observations (Contd.)

CREMATORIUM



DUMPYARD



Gram Swaraj Abhiyan

- ▣ Pradhan Mantri Ujjwala Yojana
- ▣ Saubhagya
- ▣ Ujala scheme
- ▣ Pradhan Mantri Jan Dhan Yojana
- ▣ Pradhan Mantri Jeevan Jyoti Bima Yojana
- ▣ Pradhan Mantri Suraksha Bima Yojana and
- ▣ Mission Indradhanush

Other Schemes & Initiatives:



Agriculture :- Seed Village programme, Subsidized seed programme, Rythu bandhu scheme.

Seed Village programme:

- Implemented by Krishi Vigyan Kendra, State Seed Corporation, National Seed Corporation , State Farm Corporation of India
- 50 willing farmers are provided with foundation seed

Subsidized Seed Programme:

- Sale point was established in musaphet mandal
- Good quality seed at 30% seeds are provided

Rythu Bandhu Scheme:

- Farmer investment support scheme
- Rs 4000 per acre per farmer per season is given to farmers for buying seeds, fertilizers, pesticides etc.



Health :- KCR Scheme, Amma vodi scheme

KCR scheme

- Started in month of June 2017
- A kit necessary for newborn child which includes 16 items like clothes for baby,saree for mother, good quality soap, shampoo,powder,mosquito net etc for baby

•Amma Vodi Scheme

- Launched in Jan 2018 and implemented in May 2018
- Pregnant women can call at a helpline no 102 and special vehicle will take her from home to hospital and from hospital to home after delivery
- 1 vehicle in our village for 2 Mandal



Water :-Mission Bhagirathi, Mission Kakatiya

Mission Bhagirathi

- Launched in August 2016, completed in the village in year 2017
- 3 Over Head Service Reservoir(OHSR),9 Ground Level Service Reservoir(GLSR) are constructed to provide pure drinking water.

•Mission Kakatiya

- Completed in year 2017 in our village
- Tanks and lakes are dug up for increasing water storage capacity
- 19 ponds are dug up



Electricity:-

- Gramin Vidutikaran Yojana



Others:

- Kalyan Lakshami, Arogya Lakshami Programme.

Gramin Vidhutikaran Yojana

- Started in 2015
- To provide connection to every villagers
- For Rs 125 a villagers will get a connection, Meter, Service wire from home to pillar and 1 LED bulb

Kalyan Lakshmi/Shadi Mubarak

- Started in October 2014
- A welfare scheme in which a financial aid of Rs 1,00,116 is provided to bride family of financially backward people

Arogya Lakshmi Programme

- Launched in Jan 2015
- Nutritional program for pregnant and lactating mother and her child
- 16 Eggs per month for child of age group 7 months to 3 years
- One egg daily to child of age group of 3 to 6 years
- One Egg and 200ml milk to lactating and pregnant mother for 25 days in a month

Cleanliness Drive-SBM



Positives

- ▣ 100 per cent Open Defecation Free
- ▣ 24*7 electricity available
- ▣ CC (Pucca) Road
- ▣ Active Roles by SHGs, ANM and ASHA workers
- ▣ Good Sanitary conditions
- ▣ Effective and efficient role of local level administration in Implementation and execution of policies along with people's participation.

ISSUES

- ▣ Excessive uses of fertilizers leading to deterioration of soil quality.(Current NPK ratio is 8:4:1 against the 4:2:1)
- ▣ Only one clinic in the entire village that too opens twice a week
- ▣ No fans in Anganwadi and Primary School
- ▣ No Playground in the village
- ▣ Financial literacy is very less
- ▣ Main market is 20 km away from the village

SUGGESTIONS

- ▣ Solar panels can be installed in the village.
- ▣ Alternative employment opportunities should be looked into.
- ▣ Horticulture can be promoted
- ▣ Expanding the scope of livestock.
- ▣ LPG cylinder should be provided in the Anganwadi
- ▣ Shifting to organic farming can be helpful.

THANK YOU

